



## MK-Di01-U/P



U for u type



P For P type

### General Introduction:

MK-Di01-U, used for static truck scales, supporting 1~12 pcs U protocol digital load cells  
 MK-Di01-P, used for static truck scales, supporting 1~16 pcs P protocol digital load cells

### hardware

1. power: AC switch power 110V~220V/AC;  
no DC;
2. LC interface: communication way: RS485;  
baud rate: 19200bps;  
transmit distance: less than 50m;
3. scoreboard interface: RS 232, current loop: rated baud rate is 600bps;
4. printing interface: ESPON LQ-300K+ II, KX-P1131, POS- 58...etc are optional;
5. PC communication interface way: RS232, baud rate 600~19200bps optional;

### protocol characters:

- Open protocol
- 8 bit data format, suitable for PC programming.
- Baud rate is optional, O type max to 57600.
- With function of checking LC overload record, full capacity, models...etc.
- Scalability, easy to add more function.
- Presetting all kinds of functions, like Gravity compensation and temperature compensation.
- Portability, easy to transplant to other platforms, such as CAN.

### Character 1

1. Open protocol;
2. Support U type digital LC;
3. High performance 485 communication chip;
4. LC interface have surge protection measures;
6. support auto-networking, scale group.

### Character 2

7. Support scale setting abnormal detecting
8. Auto-storage 1000 sets weighing record, no need cancel records.
9. Support PC communication interface self-detecting;
10. support RS232 and RS485 PC interface, set by software.
11. Support key diagnostic;
12. Support address checking during press angles.

### Basic function 1

- Calibration and parameter setting operated separately;
- Score board interface;
- serial communication interface;
- standard parallel print interface, customizable print format;
- Comprehensive configuration EMC electromagnetic compatibility protection measures;
- No encryption function between LC & indicator communication.
- With encryption function between LC & indicator communication (U type)
- With encryption function between LC & indicator communication (P type)

### Basic function 2

- Auto & manual adjusting of angles.
- Overload record storage and printing function.
- Digital LC code self-detecting function.
- Fast detection of digital LC condition
- Two segment values, two ranges optional
- Nonlinear correction function;
- Weighing record storage/cancel/power off protection
- Storage 500 sets truck tare weight, 1000 sets weighing records.



## MK - LU- D/P Digital Load Cell Series



### FEATURE:

- Built in lightning protection
- High precision, reliability and super stability
- Design of stainless steel ball, cup has super functions in self-restoring corner pre-adjustment
- Anti-wallop and anti side force
- Easy to installation good interchangeability
- PVC Anti rats cable protection, high temperature
- Application to truck scale, railway scale hopper scale and other weighing equipment
- MK-LU-D-U is compatible for MK-DI01-U indicator
- MK-LU-D-P is compatible for MK-DI01-P indicator

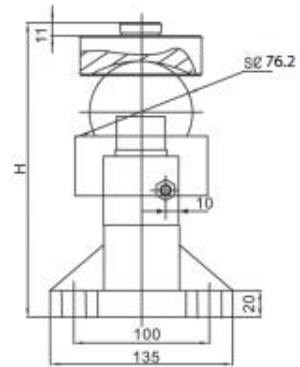
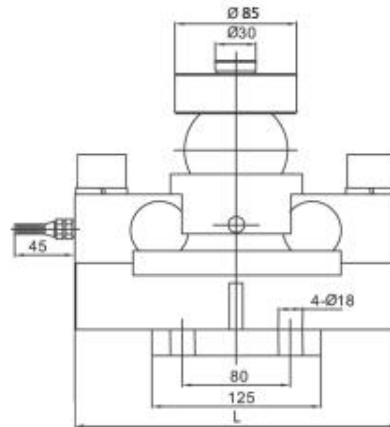
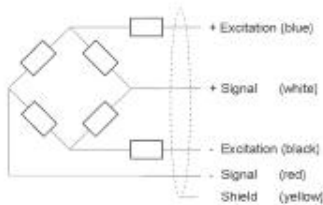

### SPECIFICATION

Rated capacities	30t	Temperature effect sensitivity	±0.02%F.S/10°C
Rated Output	30000	Temperature, operating	-30°C~+70°C
Combine error	±0.02%F.S	Maximum safe overload	150%F.S
Creep (30 min)	±0.02%F.S	Excitation, recommended	9-12V DC
Zero balance	±0.1%F.S	Excitation, maximum	20V DC
Communication Baud Rate	9600 BPS	Protection class	IP 68
Insulation resistance	≥ 2000 MΩ	Digital refurbishing	Frequency : 15
TC SPAN	±0.02%F.S/10°C	Material	Alloy steel